

Universal Gauge Sets

These gauges are used for measuring internal and external dimensions, such as grooves, shoulders, recesses, threads, tapers, gears, splines, hole centres, a wide range of measuring contacts are available to enable measurement of various features.

Bluetooth®
SMART
Option

WiFi

Option

RS232

USB



Features

- Internal and external measurement
- Range 30-255mm Internal / 0-220mm External with 20mm Anvil Travel
- Large measuring range possible 0-3000mm (0-118")
- Extensions available 150mm (Steel) 500mm and 1000mm (Carbon Fibre)
- Constant measuring force
- Supplied with digital readout
- Large range of accessories for standard measurement of threads, grooves, splines, diameters, lengths, shallow spigots and recess diameters etc
- Special anvil designs available P.O.A



TGUSER1



TGUSER2

UNIVERSAL GAUGE SETS

Code No	Description
TGUSER1	Large Set with Box
TGUSER2	Small Set with box

SET CONTENTS - TGUSER1

Code No	Description
TGU1000-XT	Universal with Box but without Indicator or Accessories
TGUA001-AN	Digital / Analogue Indicator 25mm / 0.001mm c/w COWL
TGUA006	Measuring arms 50mm (Pair)
TGUA007	Measuring Arms 75mm (Pair)
TGUA008	Measuring Arms 100mm (Pair)
TGUA013	20mm Disc Anvils for measuring grooves (Pair)
TGUA014	12mm Disc Anvils Int/Ext for measuring grooves (Pair)
TGUA011	Shoulder anvils flat outside spigot diameter (Pair)
TGUA012	Semi-cylindrical anvils for inside register diameters (Pair)
TGUA010	Depth-stops (Pair)
TGUA003	Clamping inserts (Pair)
TGUA004	Flat Measuring Anvil (Pair)
TGUA005	Spherical contacts (Pair)
TGUA009	Mounting Attachment (Pair)

SET CONTENTS - TGUSER2

Code No	Description
TGU1000-XT	Universal with Box but without Indicator or Accessories
TGUA001-AN	Digital / Analogue Indicator 25mm / 0.001mm c/w COWL
TGUA003	Clamping inserts (Pair)
TGUA005	Spherical contacts (Pair)
TGUA006	Measuring arms 50mm (Pair)
TGUA010	Depth-stops (Pair)

Note: BT denotes Bluetooth

Universal Setting Gauge

To improve the quality of your large diameter machined parts, the portable Universal Setting Gauge from Bowers has been developed as an easy to use comparator tool which can be set up next to the gauge being utilised. This Universal Setting Gauge has been designed to improve the ongoing accuracy levels; when setting the master, the spring loaded setting anvil ensures a constant force is maintained thereby giving repeat setting readings. The Universal Setting Gauge guide bars offer two adjustable supports for the pillars which are used at the airy points of the setting rod, all designed to reduce the amount of deflection. Due to its rugged construction the Universal Setting Gauge is ideally suited to the shop floor environment. It has been designed to work primarily in conjunction with the Bowers Universal Gauge and the INTEX Comparator Beam Gauge, although will allow other instruments to be set. The portability of the Universal Setting Gauge ensures that it can be utilised next to the gauge in use, so any deviations in measurements can be reset with the minimum amount of time and error.

Features

- Available in 3 different lengths:
Up to 550mm Internal - 650mm External
Up to 1050mm Internal - 1150mm External
Up to 1550mm Internal - 1650mm External
- Setting gauge has flat face contact anvils
- Ideal for use in the workshop area
- Easily adjustable gauge mounting supports
- Requires Length Setting Rods for setting (Spherical ends advised)
- Length adjustment can also be achieved by fitting an optional digital indicator (see below)
- Can be orientated vertically up to 1050mm internal / 1150 external when a base and vertical guide, (USGS) are fitted



UNIVERSAL SETTING GAUGE

Code No	Description	Range (mm)	Length (mm)
USG550	Universal Setting Gauge	550mm internal to 650mm external	550mm internal to 650mm external
USG1050	Universal Setting Gauge	1050mm internal 1150mm external	1050mm internal 1150mm external
USG1550	Universal Setting Gauge	1050mm internal 1150mm external	1550mm internal 1650mm external
USGS	Universal Setting Gauge Vertical Stand		
30-805-5501B	Digital Indicator	0-25mm, 0.001mm	
30-805-5621B	Digital Indicator	0.50mm 0.001mm	

Universal Gauge and Accessories

Digital Indicator and Protective Shroud

Code No
TGUA001-AN



Note: A denotes Analogue

Code No
TGUA001
TGUA001-BT

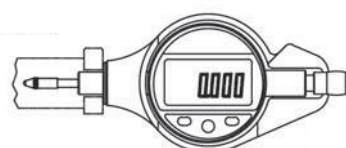

Note: BT denotes Bluetooth

Protective Shroud for Dial/Digital Indicator

Code No
TGUA002

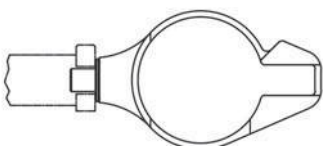

Adjustable Depth Stops for Measuring Arms

Code No
TGUA010

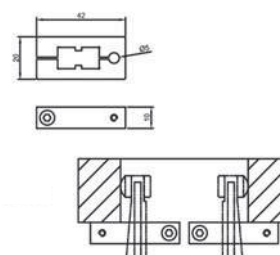

Measuring Arms

Dimn - A	Code No
50	TGUA006
75	TGUA007
100	TGUA008

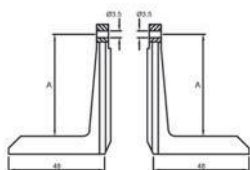

Flat Tips

Code No
TGUA004

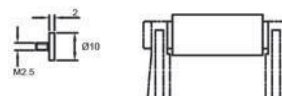

Spherical Tips

Code No
TGUA005

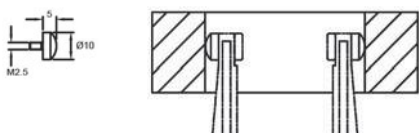

Clamping Insert

Code No
TGUA003



Mounting Attachments for use with the following Anvils

Code No
TGUA009

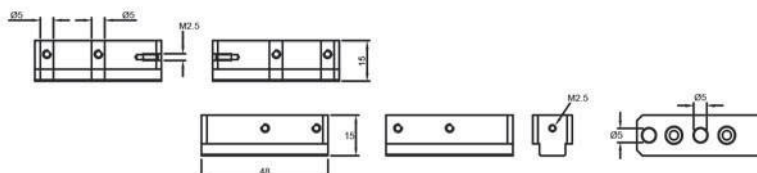

Universal Gauge and Accessories

Shoulder Anvils Flat Outside Spigot Diameter

Code No
TGUA011

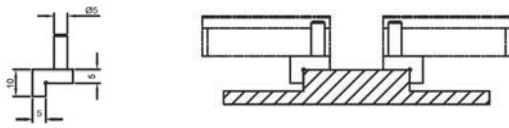

Semi-Cylindrical Anvils for Inside Register Diameters

Code No
TGUA012

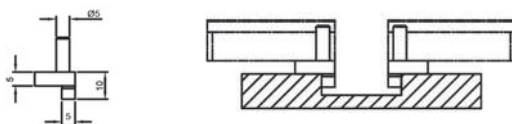

DISC Anvils for measuring Groove Diameter

Code No
TGUA013

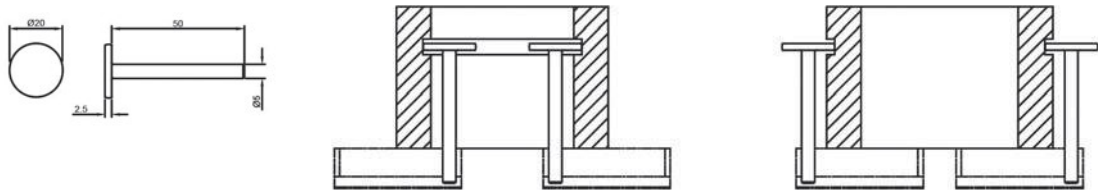

DISC Anvils for measuring Groove Diameter

Code No
TGUA014

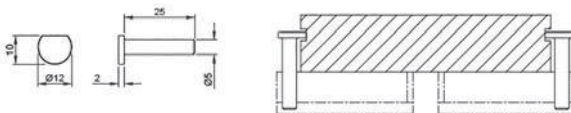

Cone Anvils for Measuring Hole Centre Distance

Code No	Dimn - D
TGUA019	13
TGUA020	25
TGUA021	50

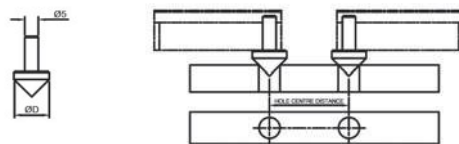

Vee Support for Length Measurement

Code No
TGUA022

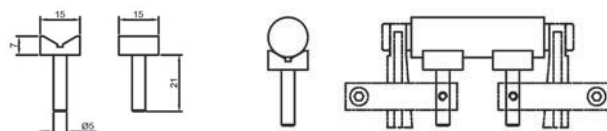

Universal Gauge and Accessories

UNIVERSAL GAUGING EXTENSIONS

Code No	Description	Length (mm)
TGUA035	Extension Steel	150
TGUA036	Extension Carbon Fibre	500
TGUA037	Extension Carbon Fibre	1000



Universal Setting Gauge up to 1550 Internal and 1650 External

